

# CENTER TOWNSHIP SECTION 14 R10- TWP 6 MORGAN COUNTY, OH

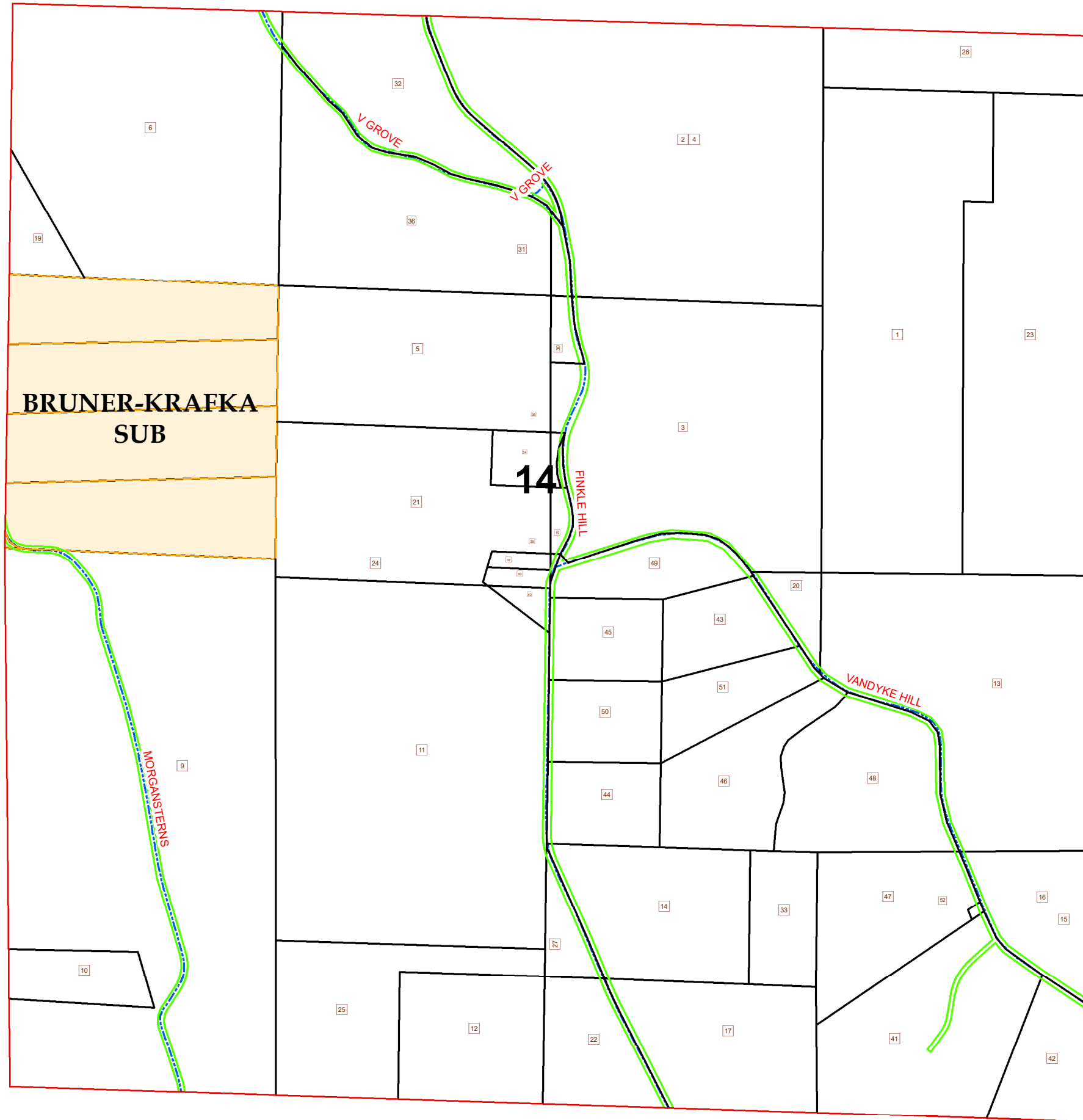

PIN	VOL	PAGE	Owner	LegalDescr	Acres
030-000-480-0	D.V	192 287	BICKFORD DANNY Z & DEBORAH	R10 T06 S14 SD 30	1
030-000-490-0	D.V	192 287	BICKFORD DANNY Z & DEBORAH	R10 T06 S14 SD 5	20
030-003-750-0	OR163	20	BURKHEIMER JAMES D & MELISSA M	R10 T06 S14 SD 10 SURVIVO	4
030-003-740-0	OR163	20	BURKHEIMER JAMES D & MELISSA M	R10 T06 S14 SD 9 SURVIVOR	76.35
030-000-470-1	OR153	230	CARY MARK ALAN	R10 T06 S14 SD 31	0.659
030-000-470-2	OR153	230	CARY MARK ALAN	R10 T06 S14 SD 36	21.181
030-001-160-0	OR230	1	CNX LAND LLC	R10 T06 S14 SD 15-16 HARR	8.533
030-005-030-0	OR230	1	CNX LAND LLC	R10 T06 S14 SD 13 R&A SCH	29.838
030-005-050-0	OR230	1	CNX LAND LLC	R10 T06 S14 SD 20 C H CLAR	2.05
030-001-140-0	OR230	1	CNX LAND LLC	R10 T06 S14 SD 23 FLORENC	31.75
030-001-130-0	OR230	1	CNX LAND LLC	R10 T06 S14 SD 1 FLORENCE	39.92
030-001-150-0	OR230	1	CNX LAND LLC	R10 T06 S14 SD 26 FLORENC	9
030-008-220-0	OR232	5131	FLEMING SHERRY L	R10 T06 S14 SD 22	6
030-008-210-0	OR232	5131	FLEMING SHERRY L	R10 T06 S14 SD 27	2
030-008-180-0	OR232	5131	FLEMING SHERRY L	R10 T06 S14 SD 14	13
030-005-050-1	OR138	541	GROS BUCKS LIMITED	R10 T06 S14 SD 43	5.112
030-008-200-0	OR232	5128	LEGG PEGGY A	R10 T06 S14 SD 12	10
030-008-190-0	OR232	5128	LEGG PEGGY A	R10 T06 S14 SD 25 SURVIVO	13.34
030-000-470-0	OR81	472	LEMASTERS TERRY L & KRISTI H	R10 T06 S14 SD 31-32	14.46
030-001-160-3	OR171	490	LEWIS CHRISTOPHER & KARI	R10 T06 S14 SD 47 SURVIVO	10.19
030-005-050-4	OR171	490	LEWIS CHRISTOPHER & KARI	R10 T06 S14 SD 46 SURVIVO	8.941
030-005-050-2	OR197	232	LEWIS CHRISTOPHER & KARRI	R10 T06 S14 SD 44 SURVIVO	5.161
030-005-050-5	OR229	929	LEWIS CHRISTOPHER D & KARRI J	R10 T06 S14 SD 50 SURVIVO	5.096
030-005-050-6	OR229	929	LEWIS CHRISTOPHER D & KARRI J	R10 T06 S14 SD 51 SURVIVO	5.045
030-001-160-1	OR138	158	LEWIS LAWRENCE W & KIMBERLY D	R10 T06 S14 SD 41 SURVIVO	16.928
030-003-690-0	OR109	11	LEWIS LAWRENCE W JR & KIMBERLY D	R10 T06 S14 SD 17	13
030-001-160-2	OR173	404	LEWIS LAWRENCE W JR & KIMBERLY D	R10 T06 S14 SD 42 SURVIVO	5.767
030-005-050-3	OR173	404	LEWIS LAWRENCE W JR & KIMBERLY D	R10 T06 S14 SD 45 SURVIVO	5.096
030-005-040-1	OR173	642	MCCREADIE SCOTTY R	R10 T06 S14 SD 49	5.076
030-005-040-0	OR233	4371	MCCREADIE TRISHA	R10 T06 S14 SD 03 C H CLAR	35.574
030-005-030-1	OR142	562	MILLER JAKE J	R10 T06 S14 SD 48	12.362
030-004-160-0	OR219	404	MORGENSTERN JOYCE A	R10 T06 S14 SD 19	2.68
030-005-060-0	OR136	74	OHIO POWER COMPANY ATTN: TAX DEP	R10 T06 S14 SD 29 C H CLAR	1
030-004-980-0	OR233	4352	PETERS TOSHA R	R10 T06 S14 SD 2-4	48.081
030-008-180-1	OR215	2751	PHILLIS DAVID M	R10 T10 S14 SD 33	5
030-007-060-1	OR233	2392	PHILLIS RODNEY M	R10 T06 S14 SD 40	0.816
030-007-050-3	OR233	2392	PHILLIS RODNEY M	R10 T06 S14 SD 39	0.698
030-007-070-2	OR233	2392	PHILLIS RODNEY M	R10 T06 S14 SD 38	0.077
030-007-050-2	OR233	2392	PHILLIS RODNEY M	R10 T06 S14 SD 37	0.463
030-007-060-0	D.V	138 375	PHILLIS STANLEY E & INA	R10 T06 S14 SD 11	52.184
030-007-050-0	D.V	138 375	PHILLIS STANLEY E & INA	R10 T06 S14 SD 21-24	21.839
030-007-070-1	OR3	606	TAYLOR PEGGY ANN C/O PEGGY ANN L	R10 T06 S14 SD 35	0.26
030-007-050-1	OR3	606	TAYLOR PEGGY ANN C/O PEGGY ANN L	R10 T06 S14 SD 34	1.74
030-000-270-0	OR89	380	TULLIUS ELIZABETH L & CAROLYN I BAR	R10 T06 S14 SD 6	38

<span style="border: 1px solid red; display: inline-block; width: 15px; height: 10px; margin-right: 5px;"></span> Sections	<span style="border-bottom: 1px solid blue; width: 15px; margin-right: 5px;"></span> Hydro	<span style="border: 1px solid black; display: inline-block; width: 15px; height: 10px; margin-right: 5px;"></span> Parcels
<b>Boundaries</b>	<span style="border-bottom: 1px solid orange; width: 15px; margin-right: 5px;"></span> Lot	<span style="border-bottom: 1px dashed blue; width: 15px; margin-right: 5px;"></span> Roads
<b>Type</b>	<span style="border-bottom: 1px solid black; width: 15px; margin-right: 5px;"></span> Parcel	<span style="border-bottom: 1px solid green; width: 15px; margin-right: 5px;"></span> ROW
<span style="border-bottom: 1px dashed purple; width: 15px; margin-right: 5px;"></span> Hidden		

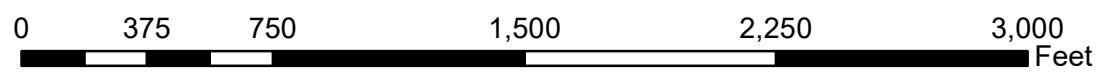

Source: Morgan County Engineer's Office  
 Author: Marcia Wolfe  
 Date: 3/17/2020

Disclaimer: The information that these maps contains is or reference purposes only. Please bring any erros to the attention of the Engineer's Office staff.  
 Thank you